



HAAS
CABINET

From Our Family to Yours

Liberty Maple

HOMESTEAD
COLLECTION
Door Styles and Finishes

MAPLE

Door Styles



BAYSIDE



CUMBERLAND



HEARTLAND



JEFFERSON



LIBERTY SQUARE/ARCH (Wall)



METRO



UPLAND



VALLEY



WOODFORD

Maple Stain and Paint Finishes

(ADDITIONAL CHARGES ON PAINTS)



HONEY



SPICE



CABERNET



SIENNA



WHITE



EGGSHELL



BLACK



LINEN

CHERRY - OAK - SEASCAPE

Door Styles



LIBERTY CHERRY



OAKRIDGE SQUARE/ARCH (Wall)



VALLEY OAK



SEASCAPE

Cherry Finishes



AUTUMN



CINNAMON



ROSE

Oak Finishes



CINNAMON



HONEY



SIENNA

OPTIONAL DOOR EDGE PROFILES

All Homestead door styles (except Bayside, Jefferson, Metro and Seascape) are available with Classic, Shaker, or Designer edge profiles. Designer edge profile is required for glazed finishes.



CLASSIC



DESIGNER



SHAKER

ACCENT FINISHES

GLAZES

(shown on White paint)



Ebony



Mocha



Taupe



Chocolate

HIGHLIGHTS

(shown on White paint)



Smoke



Umber

Glazed accents of Ebony, Mocha, and Taupe are available on most stained and painted Homestead door styles. Highlights of Smoke, Chocolate, and Umber are available on painted Homestead finishes.

These secondary accent colors help provide a custom-looking finish on these value-priced cabinets. In addition to a modest additional charge, these accent finishes require the selection of the Designer edge door profile on most door styles.

HOMESTEAD ADVANTAGE

Homestead cabinetry was developed as a value-priced product line by Haas Cabinet. While Haas specializes in true semi-custom styled products and price points, we recognize that the market for stock-priced cabinetry is substantial. Haas is proud to be able to meet that demand by gaining cost savings through offering more limited and focused selections of the most popular cabinet sizes, door style choices and finishes. This focus on production efficiencies is what allows Haas cabinet to offer the Homestead series at such competitive price points.

Haas Cabinet also recognizes that you may desire flexibility and flair that can often exceed a budget. That is the focus of Haas' Homestead Advantage Program. By utilizing this program, you can now get those unique pieces, while still staying in the Homestead budget on the remaining products. Having access to the complete Haas product line with thousands of cabinet choices, standard and optional features, and the almost limitless custom modification choices gives you the perfect complement to both meet your budget while satisfying the pursuit of your dream kitchen. Let Haas manufacture the specialty components and then match the doors and drawers to your Homestead kitchen to offer a seamless fit.

Custom pieces, value-priced products . . . available together from Haas.

SPECIFICATIONS

CABINET CONSTRUCTION

1. **Face frame.** All Homestead cabinets use a 3/4" thick solid hardwood front frame. Frames are grooved to accept the cabinet top/bottom and end panels, providing a sturdy, interlocking construction.
2. **Front frame joints.** Front frame joints are pinned and glued under pressure using a "blind" mortise and tenon joint.
3. **Toe kick.** Homestead base and vanity cabinets use a 3" deep by 4-1/2" tall toe kick. The toe support is lipped and glued into the end panels for extra support and strength.
4. **Nail stick.** Solid wood nail sticks in wall cabinets and plywood nail sticks in the bases are an integral part of Homestead cabinetry. These pieces provide a strong, secure and long-lasting mounting platform for cabinet installation. No particleboard strips or thin cabinet backs to "hold" the cabinets in place.
5. **Drawers.** All Homestead drawers are made of 1/2" thick maple plywood material. A 3.2MM thick hardwood drawer bottom is grooved into the box on all four edges and glued. This long-lasting construction technique provides years of trouble-free service to one of the most used components in your kitchen.
6. **Drawer joints.** All drawers are standard with dovetail joints on all four corners. These joints are glued under pressure and provide years of drawer structure reliability.
7. **Drawer guides.** Homestead drawers use side-mounted, epoxy-coated drawer guides.
8. **Adjustable shelves.** Most cabinets have adjustable shelves that allow the homeowner to select the opening sizes. In addition, a full array of unique pull-out products is available to maximize access to some hard-to-reach areas.
9. **End panels.** All Homestead ends are made of 1/2" thick material with 3/16" furniture offset on the outside. Upgrades to a 3/4" plywood end is available for exposed ends, if desired.



Full-extension under mount guides
with soft-close features

HOMESTEAD DRAWER UPGRADE

Available as an upgrade, any Homestead drawer may be changed to feature solid wood dovetailed drawers and full-extension, under mount, ball bearing drawer guides with soft-close features.

Drawers are the most used feature on your cabinetry. This new upgrade choice allows you to choose a true custom-styled drawer in a budget-conscious kitchen.



Drawer Upgrade Comparison

SPECIFICATIONS

BASES (All base cabinets are 34-1/2" high, 24" deep.)

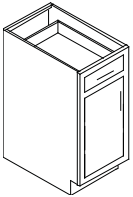
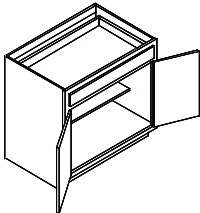
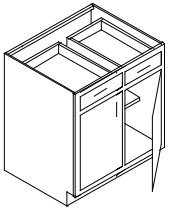
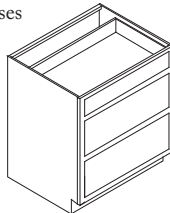
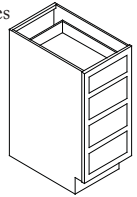
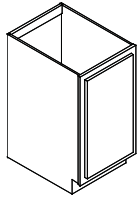
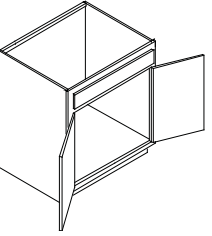
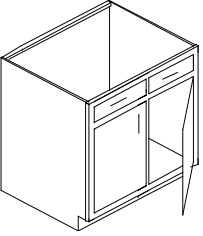
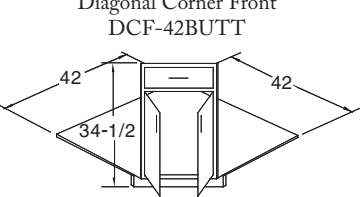
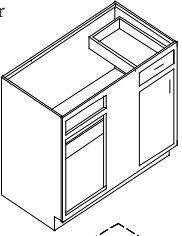
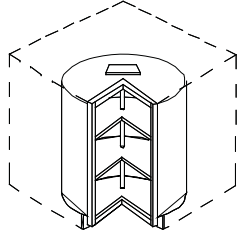
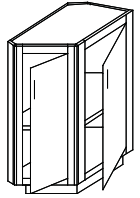
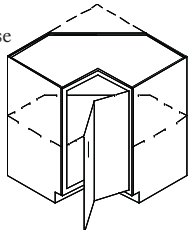
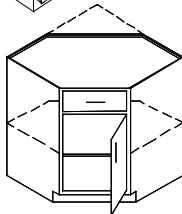
| | | | | | |
|---|--|--|--|--|--|
| <p>Base Single Door B12R/L B15R/L B18R/L B21R/L B24R/L</p>  | <p>Base Butt Door B24BUTT B27BUTT B30BUTT B33BUTT B36BUTT</p>  | <p>Base Double Door B30 B33 B36 B39 B42 B48</p>  | <p>3-Drawer/Tray Bases DB12-3 DB15-3 DB18-3 DB21-3 DB24-3 DB30-3</p>  | <p>4-Drawer/Tray Bases DB12-4 DB15-4 DB18-4 DB21-4 DB24-4 DB30-4</p>  | <p>Full Height Single Door FHB9R/L FHB12R/L FHB18R/L</p>  |
| <p>Sink Base Butt Door SB24BUTT SB27BUTT SB30BUTT SB33BUTT SB36BUTT</p>  | <p>Sink Base Double Door SB30 SB33 SB36 SB39 SB42 SB48</p>  | <p>Diagonal Corner Front DCF-42BUTT</p>  | <p>Base Corner BC36R/L BC42R/L</p> <p>Right-hand shown</p>  | <p>Lazy Susans RDLS36 LS33R/L LS36R/L Super Susan R/L</p>  | |
| | <p>Angled Based BEC12R/L</p> <p>Right-hand shown</p>  | <p>"L" Corner Base LCB36R/L</p>  | <p>Diagonal Corner Base DCB36R/L</p>  | | |

UTILITIES/OVENS 84", 90", 96" (84" and 90" tall has attached toe. 96" tall has detachable toe.)

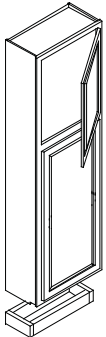
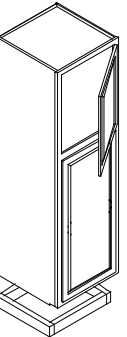
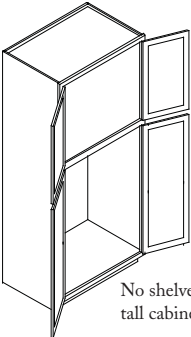
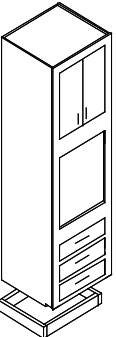
| | | | |
|---|--|--|---|
| <p>Utilities 84" Tall 12" Deep U1512R/L U1812R/L U2412R/L</p>  <p>No shelves shipped in tall cabinets</p> | <p>Utilities 84"/90"/96" Tall 24" Deep U1524-84R/L U1824-84R/L U2424-84R/L U1524-90R/L U1824-90R/L U2424-90R/L U1524-96R/L U1824-96R/L U2424-96R/L</p>  <p>No shelves shipped in tall cabinets</p> | <p>Utilities 30" Wide (butt door) U3024-84BUTT U3024-90BUTT U3024-96BUTT</p>  <p>No shelves shipped in tall cabinets</p> | <p>Ovens OV3084BUTT OV3090BUTT OV3096BUTT OV3390BUTT OV3396BUTT</p>  <p>No shelves shipped in tall cabinets</p> |
|---|--|--|---|

Microwaves
MICRO2734
MICRO3034
MICRO2740
MICRO3040
MICRO2746
MICRO3046

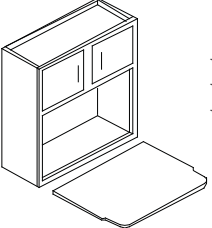

Wall Ends
12" Deep
WEC30R/L
WEC36R/L
WEC42R/L
Glass shelves

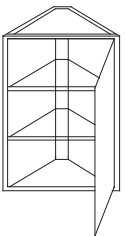

Wine Racks
WR3615
WR3018
WR3618
WR2430

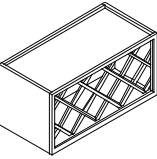

Interior is finished veneer

WALLS

CLHood30
CLHood36

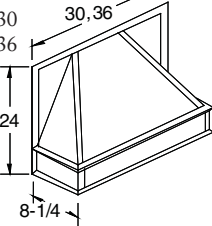

Walls
12" High
W3012
W3312
W3312-24Deep
W3612
W3612-24Deep
W3912
W3912-24Deep

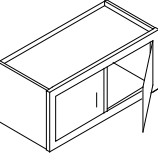

Walls
15" High
W3015
W3315
W3315-24Deep
W3615
W3615-24Deep
W3915
W3915-24Deep

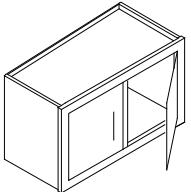

Vinyl interior.
Trim Kit Part No. - MWI wood interior kit

390 CFM vent kit available

SPECIFICATIONS

WALLS continued

Walls
18" High
W2418
W3018
W3318
W3318-24Deep
W3618
W3618-24Deep
W3918
W3918-24Deep

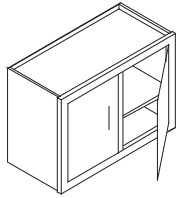

Walls
24" High 27" High
W3024 W3027
W3324
W3324-24Deep
W3624
W3624-24Deep
W3924-24Deep

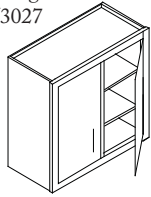

Walls
30" High
W930R/L
W1230R/L
W1530R/L
W1830R/L
W2130R/L
W2430R/L

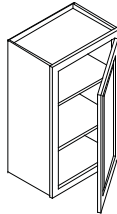

Walls
30" High
W2430BUTT W3030
W2730BUTT W3330
W3030BUTT W3630
W3330BUTT W3930
W3630BUTT W4230
W4830

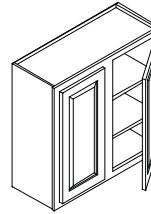

Walls
36" High
W936R/L
W1236R/L
W1536R/L
W1836R/L
W2136R/L
W2436R/L

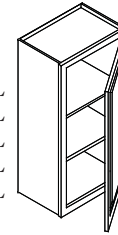

Walls
36" High
W2436BUTT
W2736BUTT
W3036BUTT
W3336BUTT
W3636BUTT
W3036
W3336
W3636

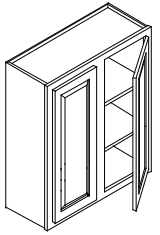

Walls
42" High
W942R/L
W1242R/L
W1542R/L
W1842R/L
W2142R/L
W2442R/L

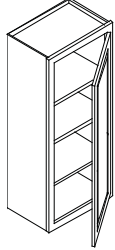

Walls
42" High
W2442BUTT W3042
W2742BUTT W3342
W3042BUTT W3642
W3342BUTT
W3642BUTT

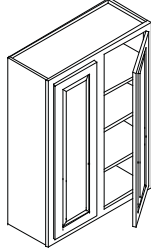

Wall Corner Angles
30"/36"/42" High
24"/27" Deep
WCA2430R/L
WCA2436R/L
WCA2736R/L
WCA2442R/L
WCA2742R/L

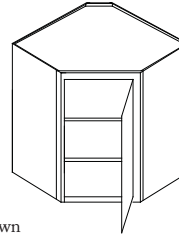

Right-hand unit shown

Wall Corners
30"/36"/42" High
WC2430R/L WC3036R/L
WC3030R/L WC3636R/L
WC3630R/L WC2442R/L
WC2436R/L WC3042R/L
WC3642R/L

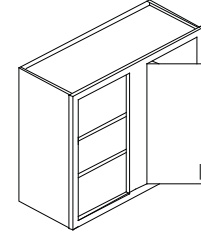

VANITIES (All vanity cabinets are 21" deep.)

Vanities
29-1/2" High
VF18

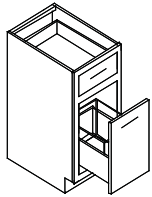

Vanity Basin Bases
29-1/2" High
VBB24BUTT
VBB27BUTT
VBB30BUTT

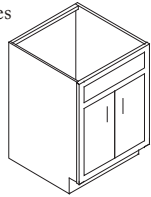

Vanity Basin Bases
29-1/2" High
VBB36
VBB42

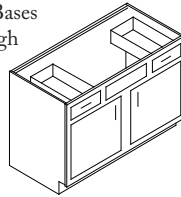

Vanity Basin Bases
29-1/2" High
VBB48

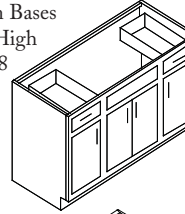

Vanity Basin Bases
29-1/2" High
VBB60-1BOWL

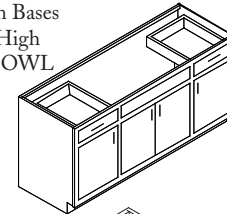

Vanity Drawer
Basin Bases
29-1/2" High
VDBB27R/L
VDBB30R/L
VDBB36R/L
Left-hand
unit shown

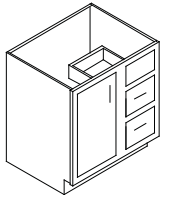

Vanity Drawer
Basin Bases
29-1/2" High
VDBB42R/L
VDBB48BUTT*
*2-drawer stacks

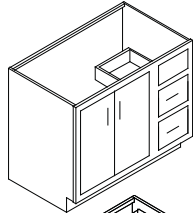

Vanity Drawer
Basin Bases
29-1/2" High
VDBB60-
2BOWL

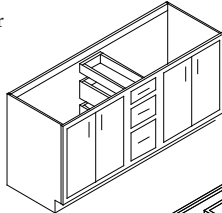

Vanity Bases
29-1/2" High
VB15R/L
VB18R/L

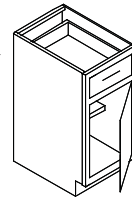

Vanity Drawer
Bases
29-1/2" High
VDB12
VDB15
VDB18

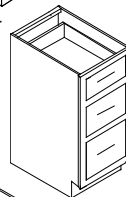

BHVanity Basin
Bases
34-1/2" High
BHVBB24BUTT
BHVBB27BUTT
BHVBB30BUTT

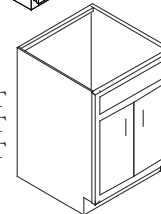

BHVanity Basin
Bases
34-1/2" High
BHVBB36
BHVBB42

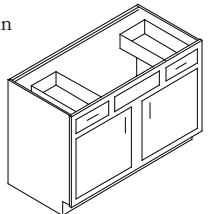

BHVanity
Basin Bases
34-1/2" High
BHVBB48

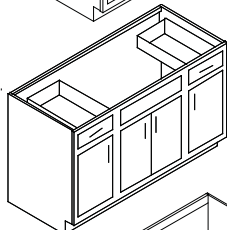

BHVanity Basin
Bases
34-1/2" High
BHVBB60-
1BOWL

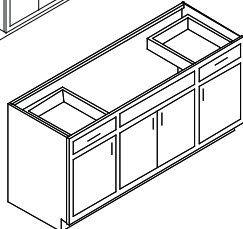

BHVanity Drawer
Basin Bases
34-1/2" High
BHVDBB27R/L
BHVDBB30R/L
BHVDBB36R/L
Left-hand
unit shown

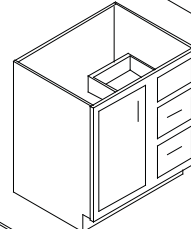

BHVanity Drawer
Basin Bases
34-1/2" High
BHVDBB42R/L
BHVDBB48BUTT*
*2-drawer stack

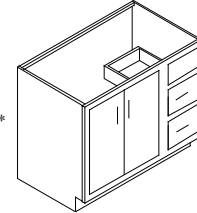

Vanity Linen
84" High
VLC1821R/L

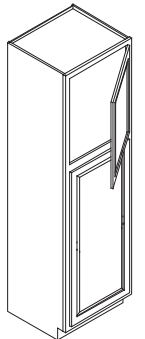

BHVanity Drawer
Basin Bases
34-1/2" High
BHVDBB60-
2BOWL

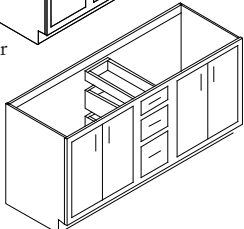

BHVanity Bases
34-1/2" High
BHVBB15R/L
BHVBB18R/L

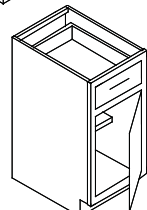

BHVanity
3-Drawer Bases
34-1/2" High
BHVDB12
BHVDB15
BHVDB18

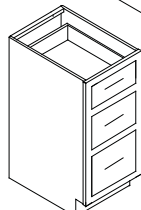

BHVanity
4-Drawer Bases
34-1/2" High
BHVDB12-4
BHVDB15-4
BHVDB18-4

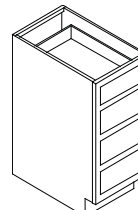

Knee Drawer
KD36
5-1/2"

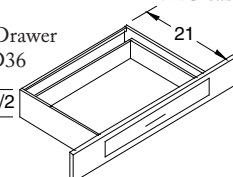

No shelves
shipped in
VLC cabinet



Haas Cabinet Co., Inc.
625 W. Utica Street • Sellersburg, IN 47172
Direct: 812.246.4431 • Toll-free: 888.TRY.HAAS
haascabinet.com



MADE IN THE U.S.A.



KCMA
Certification Seal



©2012 Haas Cabinet Co., Inc. All rights reserved. Products featured in this brochure are designed for long life and color performance. However, slight color changes may occur over time from contact with smoke, ultraviolet light and other contaminating sources. Variations of color and grain are to be expected in each cabinet as they reflect the natural beauty of hardwood and should not be considered a material defect. Color variations in photos may occur during the printing process. Products may be shown with optional features and finish selections. Hardware must be purchased separately. Visit your Haas dealer to view finished wood samples. Haas Cabinet Co., Inc. reserves the right to make changes in products and selection without notice.